

INFOSHEET | MAGICINFO ADD-ON



Q-Image: Transforms HTML content into ready to use images

Table of contents

Introduction 3

About Q-Image 4

How Q-Image works 5

Supports any MagicINFO player 6

Q-Image requirements 7



LEVEL UP!

Q-Image transforms web content into images

Even with poor internet your web content can still be published stably



Automate your content

It is not so self-evident that organizations have a stable internet connection, or that their entire display network is equipped with the newest technologies. Yet, when you use a digital signage solution, these are indispensable factors to make good use of the advantages that digital signage offers. One of the big advantages is being able to publish web content. More and more companies are opting for this because it is less labour-intensive due to automation and therefore less error-prone.



Publish web content stable

When you have to work with a legacy of older displays that are not supporting the use of web content, or have to deal with poor internet connections, publishing web content is causing problems. Perhaps it's not even possible at all. Are you struggling to get your web content on your display? Q-Image is the MagicINFO add-on that converts web URLs into an easy-to-use image and transfers this to your MagicINFO account. It's as easy and stable as that!

LEVEL UP!

About Q-Image

Change every URL into a usable image

Q-Image will transfer a URL into an image and upload it directly to the MagicINFO server, ready to publish. Interval settings and version control information will be updated, content is store to play and updates automatically.

Steady content delivery

The image is uploaded to the MagicINFO server and it can be used in a playlist. Once the image is scheduled, the system will notice data changes based on a set interval and replaces the running image with the newly updated one. With version control and the store-to-play feature of the Samsung hardware, the content will now be published in a stable matter.

Q-image is a solution for organization who:

- are not able to get web content on display
- experiencing difficulties by getting information from another sources published
- have Orsay displays in their network that they want to use with web content



How Q-Image works

Powerful simplicity combined with smartness

Q-Image works by creating a snapshot of a webpage. This snapshot will be automatically uploaded to your MagicINFO account and send to the display as an image.

Direct connection to MagicINFO

Q-Image requires a direct connection to MagicINFO server. All snapshots are automatically uploaded into your MagicINFO environment. There you find the snapshots as .jpg files provided with a time stamp for version control. You can create playlists with the uploaded images and use all publishing features of MagicINFO as you wish.

Snapshot interval

Within Q-Image you determine the interval of the snapshots. This depends on your needs and how often the information on the webpages changes. Every time a new snapshot is taken, it will overwrite the previous one. This way the latest snapshot of the webpage, is always published.

Seamless transitions

Using Q-Image means you can count on a seamless transition between content items. That's because it's an image file instead of loading a full webpage. This requires less downloading time and a decrease of data traffic.

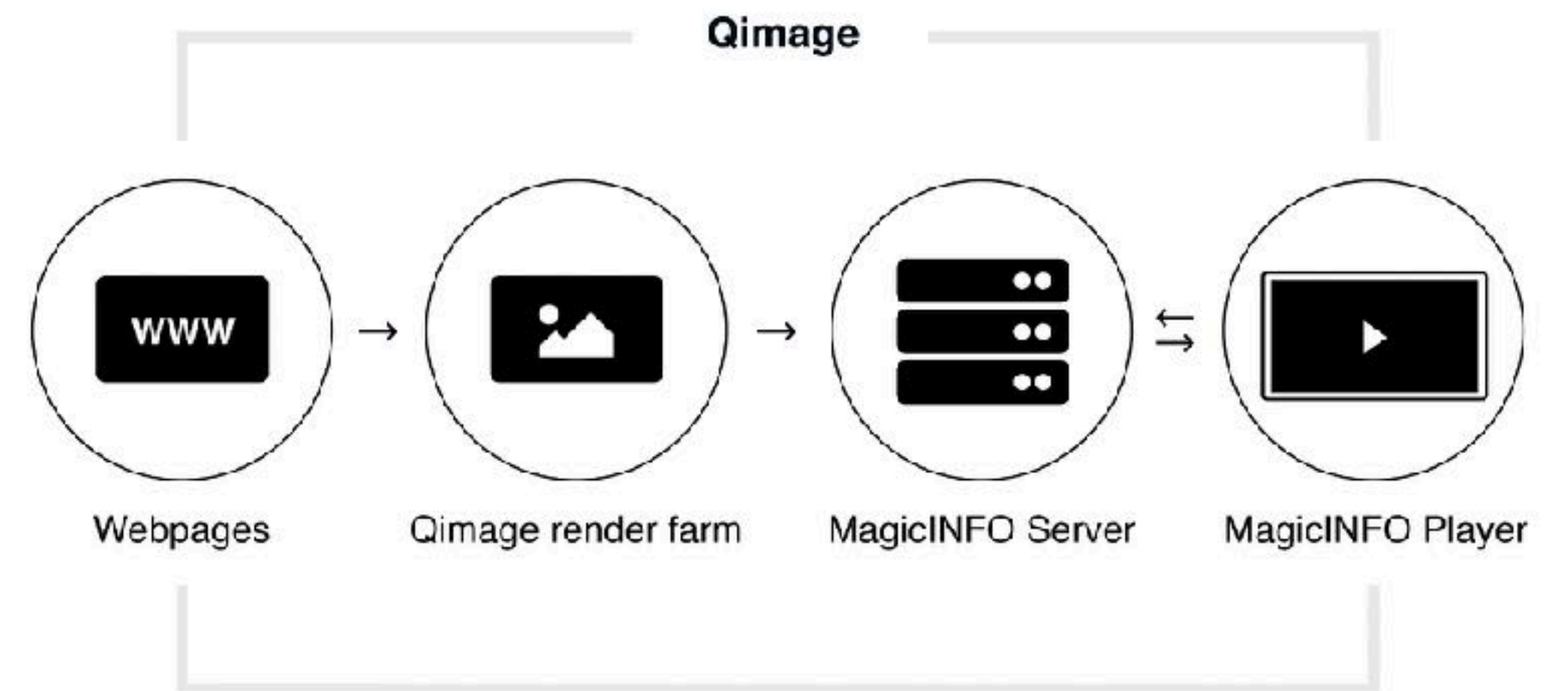

LEVEL UP!

Supports any MagicINFO player

Content automation available for any player type

Q-Image is built to overcome publishing issues working with web content. Issues caused by poor internet connection or older player versions. That's all solved with Q-Image.

Works with Orsay displays

Q-Image is suitable for organizations with a display network containing devices equipped with S1/S2 and S3 players (Orsay). These displays struggled to show web content properly, but thanks to Q-Image this is now possible.

Works with Lite players

Q-Image offers the possibility to make a ground-breaking difference. You can show webpages on MagicINFO Lite connections! This is because the snapshot of the HTML content will be uploaded as a jpg image, which can perfectly be used for MagicINFO Lite players.

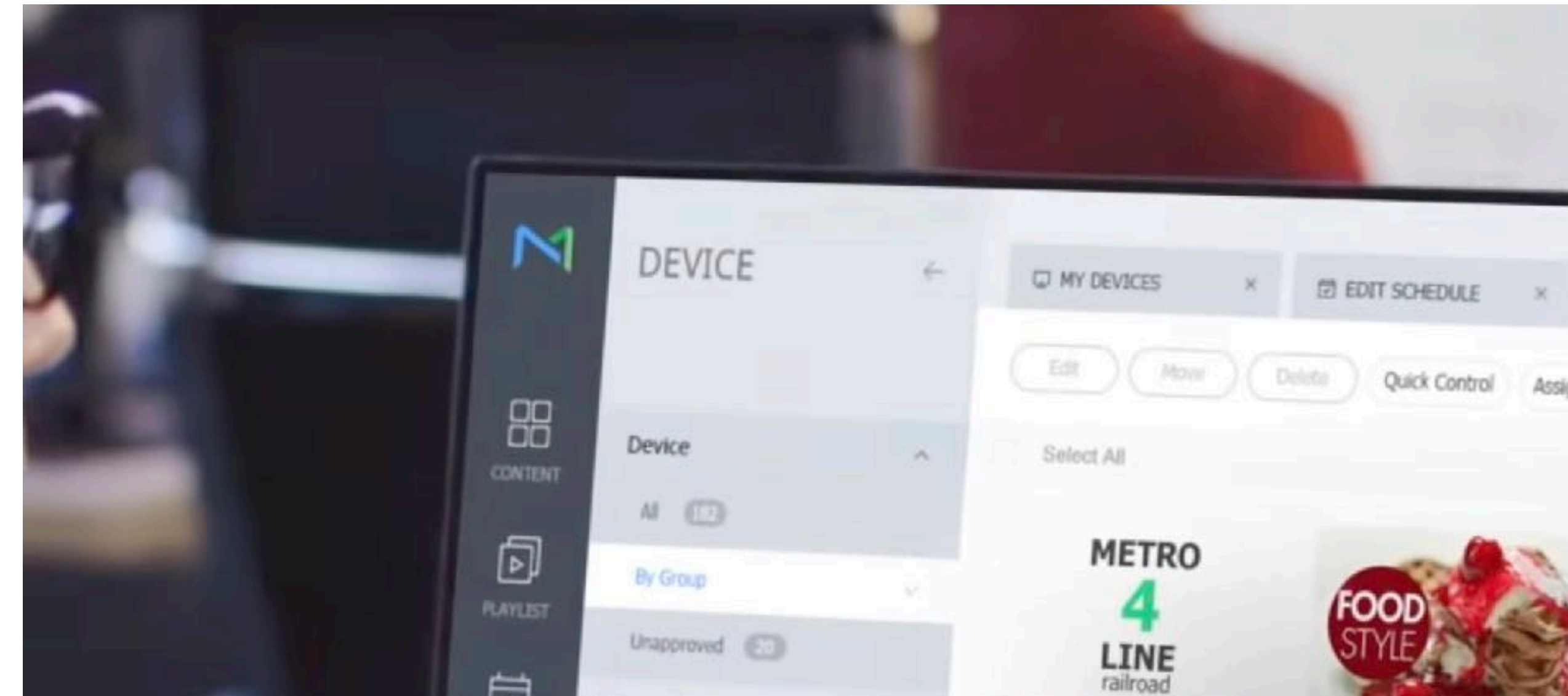

Works with Premium players

However, devices with TizenOS, S4 and higher, publish web content perfectly fine. There can still be a reason why adding Q-Image to MagicINFO Premium. There are factors like poor internet or a failing connection between datasources, interrupting the smoothness of the web content. These factors can be overcome, using Q-Image as the MagicINFO add-on.

LEVEL UP!

Q-Image requirements

Need-to-haves using Q-Image

MagicINFO Player

In order to use Q-Image there are not many hard requirements, it is designed for the S1/S2/S3 players with the poor ability to show web content. However, displays with all type of players can use Q-Image. Such as the S1 player up to the latest S10 player, but also displays with Lite players.

MagicINFO solution

A requirement is to have a MagicINFO environment (cloud or on-premise) and a Q-Image subscription. Q-Image comes with a base subscription price and on top of that additional costs for the number of snapshots made.

Web content

Q-Image needs a source, a HTML, to take the snapshot from. So whether it's a basic webpage, a created widget, a system; the HTML you connect to Q-Image will be used. It also supports Javascript content and usage exports are possible too.



| Q-Image requirements | |
|---|---|
| Samsung Digital Signage Display with an embedded Lite or Premium player | ✓ |
| MagicINFO Lite or Premium/Unified cloud connection or MagicINFO Lite or Premium/Unified license | ✓ |
| Webpage to retriever content from | ✓ |

LEVEL UP!

More information

Let's talk!

Pricing Q-Image

Q-Image comes with a base subscription price and on top of that additional costs for the number of snapshots made. Next to this you will need a MagicINFO server with activated Lite or Premium license or a Lite or Premium cloud subscription. MagicInfo Services can deliver both the licenses and the cloud subscriptions. Because pricing is depending on needs, we have to take a closer look to your specific situation.

Discuss your project

You can easily schedule an online meeting with one of our consultants using the button Schedule a meeting.

SCHEDULE A MEETING

You can easily schedule an online meeting with one of our consultants using the button here above.

LEVEL UP!



About MagicInfo Services by ScreenCom

A trusted partner from Samsung

MagicInfo Services is the all-in-one specialist for data-driven future ready digital signage solutions on the Samsung MagicINFO platform. We support enterprises and businesses that want to achieve more through effective communication by using the MagicINFO digital signage system.

We bring your MagicINFO system to the next level with high class cloud environment & device and data management with extensive monitoring and reporting capabilities. Realizing any signage concept and improve processes by creating new add-ons and utilities to maximize results.

With more than 10 years of experience in training, support, and consultancy we offer our solutions with the highest service & quality within 24hrs.



LEVEL UP!

About

MagicInfo Services is the knowledge platform for Samsung digital signage software and official distributor of MagicINFO licenses and cloud solutions. With a team of MagicINFO experts the company supports every MagicINFO end-user with high quality support, consultancy and additional signage solutions.

MagicInfo Services a trademark of ScreenCom B.V. based in The Netherlands.

For more information about MagicInfo Services please visit www.magicinfoservices.com



Address

Hoogveen 3-5
9501 XK Stadskanaal
The Netherlands

Phone

+31 (0) 85 2736428

E-mail

info@screencom.eu

Website

www.screencom.eu

MagicInfo Services

Powered by Screencom

